

Instruction Manual



Model:HP-580SB 2.1Ch Audio Sound Bar

**READ THESE INSTRUCTIONS COMPLETELY
BEFORE USE AND KEEP FOR FUTURE REFERENCE.**

Contents

	Page
Contents	1
Important Safety Instructions	2
01 Before you start	
Introduction	3
Replacing the battery	3
Hints on installation	3
02 Controls and locations of parts	
Main unit	4
Remote control	5
03 Connections	
Rear panel	6
Front panel	6
04 Basic operation	
Source control	7
Sound control	7
Surround control	7
05 Additional information	
Troubleshooting guide	8
Specifications	8

IMPORTANT SAFETY INSTRUCTIONS

The following safety precautions should always be followed when using domestic electrical products to reduce the risk of electric shock, personal injury or fire. It is important to keep these instructions for future reference after you have read and understood them and before attempting to use this product.

- This is a domestic electrical product, which must only be used for its intended purpose, in accordance with these instructions. The product should never be used in a commercial environment.
- Check the rating plate to ensure that the correct input voltage is being supplied to the product.
- Always switch the product off and remove the plug from the wall socket when not in use and before cleaning or changing accessories.
- Always ensure the product is switched off before connecting it to the power supply.
- Never reach for an electrical product that has fallen into water. This may lead to an electric shock. Switch off the power at the wall socket and disconnect the plug before attempting to remove it from the water. After removing, never attempt to re-connect the product until it has fully dried and been tested and approved by a qualified technician.
- This electrical device is not designed to be used by children. Any child using this electrical product should be closely supervised by an adult to ensure all instructions and safety precautions are adhered to.
- Never allow the power cable to come into contact with a heat source, water or any other liquid.
- Never carry this product by the power cable as it could cause damage resulting in electrical failure when it is used again.
- Never operate this product if the cable or plug is damaged. NOTE: Only a qualified electrician should attempt repair.
- Be aware that many electrical products tend to become hot during use. Never touch the appliance when it is hot. Turn off the unit when not in use.
- Never operate this product with wet hands. Always ensure your hands, the device and work area, are dry before switching on.
- Never use this product outdoors. This product is designed for indoor use only.
- The ventilation should not be impeded by covering the ventilation openings with items, such as newspapers, table-cloths, curtains, etc.
- No naked flame sources, such as lighted candles, should be placed on the apparatus.
- It shall not be exposed to dripping or splashing and that no objects filled with liquids, such as vases, shall be placed on the apparatus.
- Do not place the product in closed bookcases or racks without proper ventilation.
- Where the power plug is used as the disconnect device, the disconnect device shall remain readily operable.
- If this product stops working, switch off and unplug the product immediately. Seek professional advice before attempting to re-use this product.



WARNING

To reduce the risk of fire or electric shock, do not expose this appliance to water or moisture. There are no user-serviceable parts inside. Refer servicing to a qualified electrician.

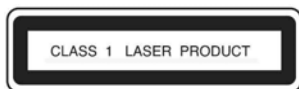

CAUTION

Visible and invisible laser radiation when open and interlocks defeated. To prevent direct exposure to laser beam, do not try to open the enclosure.



is a trademark of SRS Labs, Inc. WOW technology is incorporated under license from SRS Labs, Inc.

WOW® significantly improves the playback quality of audio, delivering a dynamic 3D entertainment experience with deep, rich bass.

01 Before you start

Introduction

Congratulations on purchasing the HP-580SB 2.1Ch Audio Sound Bar. Please read this instruction manual to learn about the features and controls of this unit.

Replacing the battery

The remote control uses a pre-installed 3-volt lithium battery. Should the remote control start to work unreliably, replace the battery with a new one of the same type.

Open the battery compartment. Before you take out the battery, please memorize its position. Otherwise, the remote control will not work and may be damaged. Remove the old battery and replace with a new one. Return the battery mounting into position.

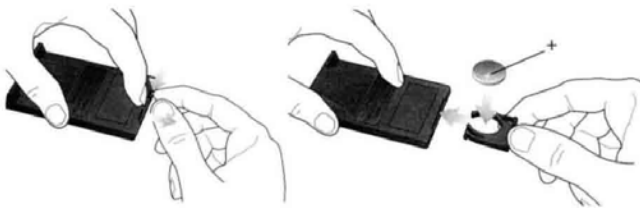

IMPORTANT

- ☒ Do not use or store batteries in direct sunlight or other excessively hot places, such as inside a car or near a heater. This can cause batteries to leak, overheat, explode or catch fire. It can also reduce the life or performance of batteries.
- ☒ When disposing of used batteries, please comply with governmental regulations or environmental public instruction's rules that apply in your country/area.



Hints on installation

We want you to enjoy using this product for many years so please use the following guidelines when choosing a suitable location:

Do...

- ☒ Use in a well ventilated room.
- ☒ Place on a solid, flat, level surface, such as a table, shelf or stereo rack.

Don't...

- ☒ Use in a place exposed to high temperatures or humidity, including near radiators and other heat-generating appliances.
- ☒ Place on a window sill or a place where the player will be exposed to direct sunlight.
- ☒ Use in an excessively dusty or damp environment.
- ☒ Place directly on top of an amplifier or other component in your stereo system that becomes hot in use.
- ☒ Use on a thick rug or carpet, or cover with cloth – this may prevent proper cooling of the unit.
- ☒ Place on an unstable surface, or one that is not large enough to support all four of the unit's feet.

02 Controls and location of parts

Main unit

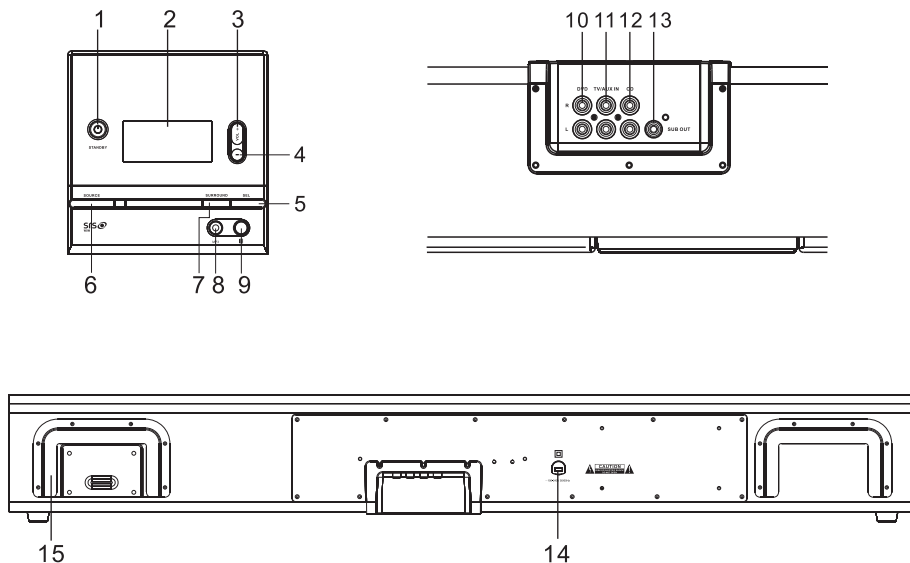

1 STANDBY

Press to turn ON the unit or put it on 'Standby' mode.

2 LCD DISPLAY

Increase sound volume level.

3 VOLUME UP

Decrease sound volume level.

5 SEL (Select)

Select Treble, Bass or Balance adjustment.

6 SOURCE

Select music source.

7 SURROUND

Enable/disable Surround mode.

8 MP3 (AUX-IN)

Insert external audio source using 3.5-mm stereo connector.

9 REMOTE IR SENSOR

10 DVD IN JACKS

11 TV IN JACKS

12 CD IN JACKS

13 SUBWOOFER OUT

14 POWER IN JACK

15 WALL MOUNT BRACKET

Remote control

1 STANDBY

Press to turn ON the unit or put it on 'Standby' mode.

2 TREBLE -

3 BASS -

4 BALANCE -

5 VOLUME -

6 SURROUND

Enable/disable Surround mode.

7 DVD

DVD source select button

8 MUTE

Enable/disable sound output.

9 TREBLE +

10 BASS +

11 BALANCE +

12 VOLUME +

13 MP3

MP3 source select button.

14 TV

TV source select button.

15 CD

CD source select button.

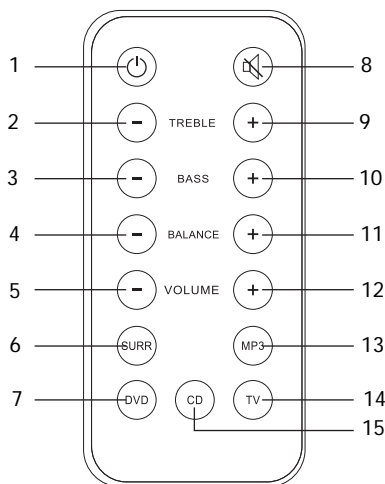

Using the remote control

Keep in mind the following when using the remote control.

- Make sure that there are no obstacles between the remote and the remote sensor on the unit.
- The remote has a range of about 6 m (19.7 ft.).
- Remote operation may become unreliable if strong sunlight or fluorescent light is shining on the unit's remote sensor.
- Remote controllers for different devices can interfere with each other. Avoid using remotes for other equipment located close to this unit.
- Replace the batteries when you notice a fall off in the operating range of the remote.

03 Connections

Rear panel

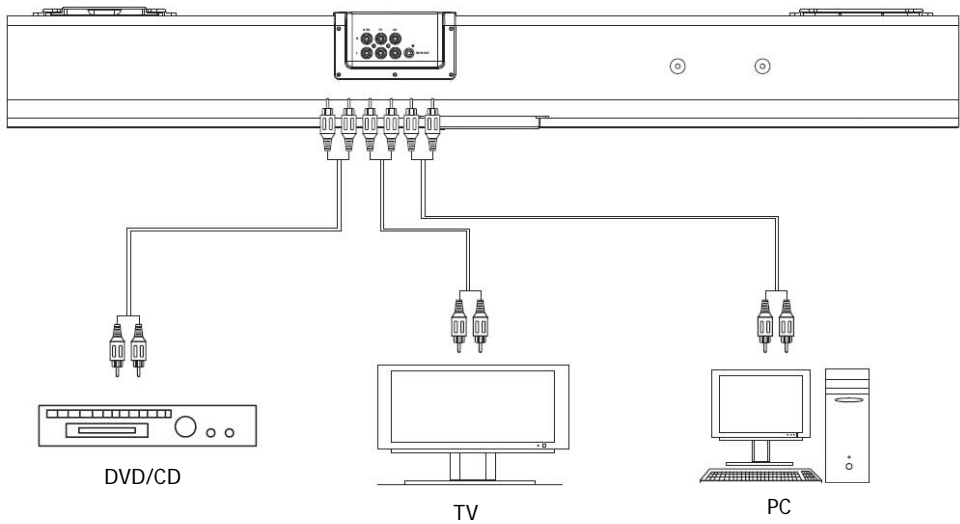

Front panel

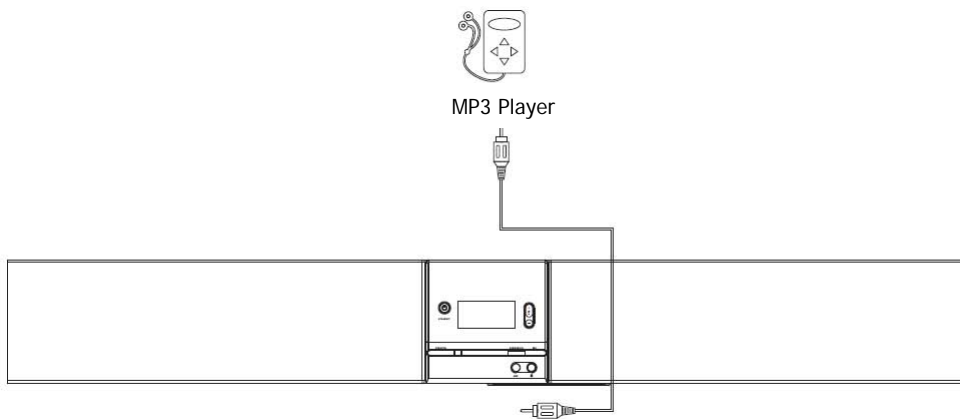

04 Basic operation

Your system is ready to use as soon as you plug it in and turn it on. Simply press **STANDBY** to activate your system.

Source control

The system has 4 audio input modes:

- DVD In
- TV In
- CD In
- MP3 (AUX In)



DVD MODE



TV MODE



CD MODE



MP3 (AUX) MODE

The default mode set to CD In. Press **SOURCE** to select the audio signal input source.

Sound control

Press **VOLUME +/-** to adjust system volume.

Press **TREBLE +/-** and **BASS +/-** to adjust music tonality.

Surround control

Press **SURROUND** to listen a virtual surround environment.

Press **SURROUND** again to return to Stereo sound mode.

Press **BALANCE +/-** to adjust the balance of sound to the right or left.



BALANCE CONTROL

05 Additional information

Troubleshooting guide

If the unit encounters any problem, please check the following first before seeking service.

No power/No display.

- Check that the power cord is connected securely.

No sound.

- Make sure the audio source is turned on, and a music track is selected and playing.
- Volume set at minimum. Increase the volume level.

Sound is too low.

- Increase volume setting of the audio source.
- Volume set at minimum. Increase the volume level.

System does not respond to remote control.

- The batteries in the remote are weak: Put in new ones.
- The distance between the remote and the player is too far: use the remote within its operating range.
- The remote is not pointed at the remote sensor of the player.
- There are obstacles between the remote and the player.
- Unplug the power cable for 1 minute, and then plug it back in. This will reset the system.

Specifications

AC power supply	:	AC 100-240V 50/60HZ
Dimensions	:	41 3/8"W x 4 7/8"H x 4 5/8"D
Net weight	:	5.5 kg
Woofer	:	4", 80 W
Mid-range	:	2.75", 60 W x 2
Total Power	:	60W x 2 + 80W x 1
Frequency response	:	55 Hz ~ 20 kHz
S/N	:	>95dB
Input Sensitivity	:	Woofer: 320mV
	:	Mid-range: 500mV

